

Double Post Kit Parts List and Schematics

Pumps

- 1 x 250psi Stainless Vane Pump
- 1 x 3/4hp 120/240v AC drive motor
- 1 x vane pump band clamp

Filters/Housings

- 1 x Intake strainer assembly
- 1 x Stainless 10" prefilter housing
- 2 x 4040 Stainless Membrane Housing Kit
- 1 x bolt kit
- 1 x Styrofoam spacer

Hose

- 3 x stainless high pressure hose
- 25' 1/2" OD HDPE tubing (discharge tubing)

Fittings

- 5 x 1/2" mnpt x 1/2" push connect straight
- 2 x 1/2" stem x 1/2" push connect elbow
- 2 x 1/2" stem plug
- 2 x 1/2" push connect T fitting
- 5 x 90 street elbow fitting
- 2 x 1/2" mnpt x 1.5" nipple
- 2 x 1/2" mnpt x 2.5" nipple
- 2 x 1/2" female "t"
- 1 x 1/2" npt flow valve
- 1 x 1/2" mnpt x 1/4" fnpt reducing bushing
- 1 x 1/2" mnpt x fnpt isolation/drain valve
- 1 x 1/4" mnpt pressure gauge

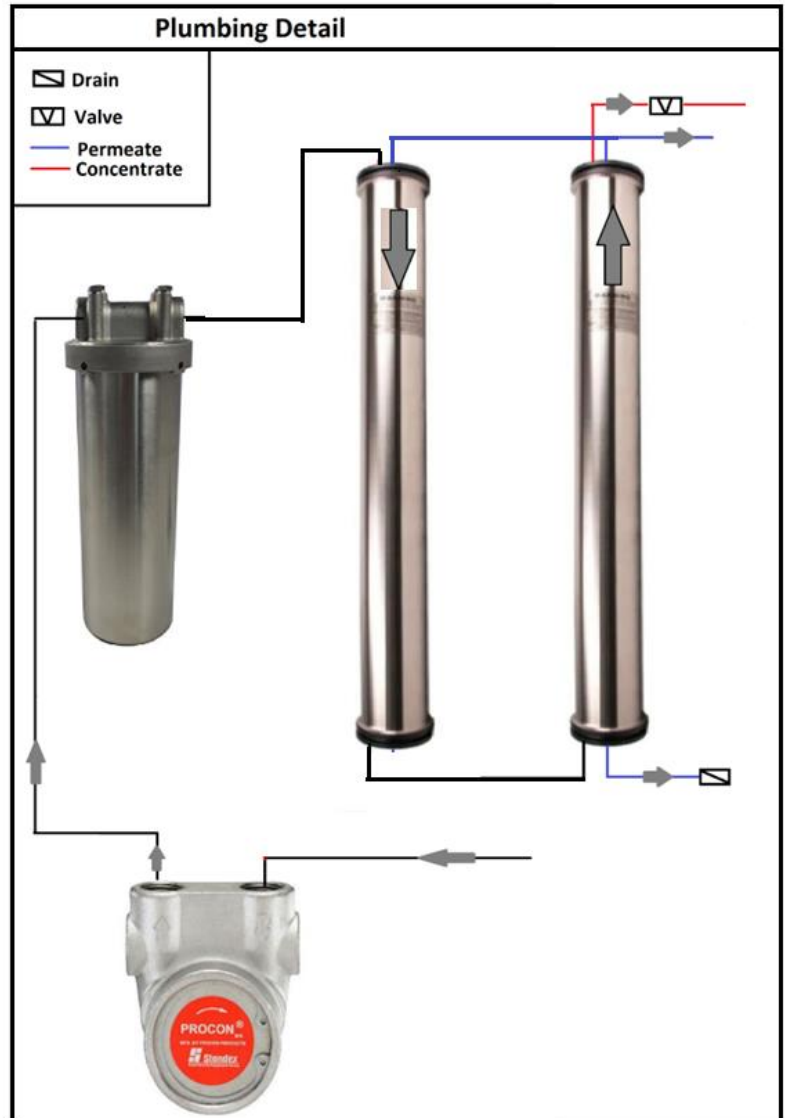

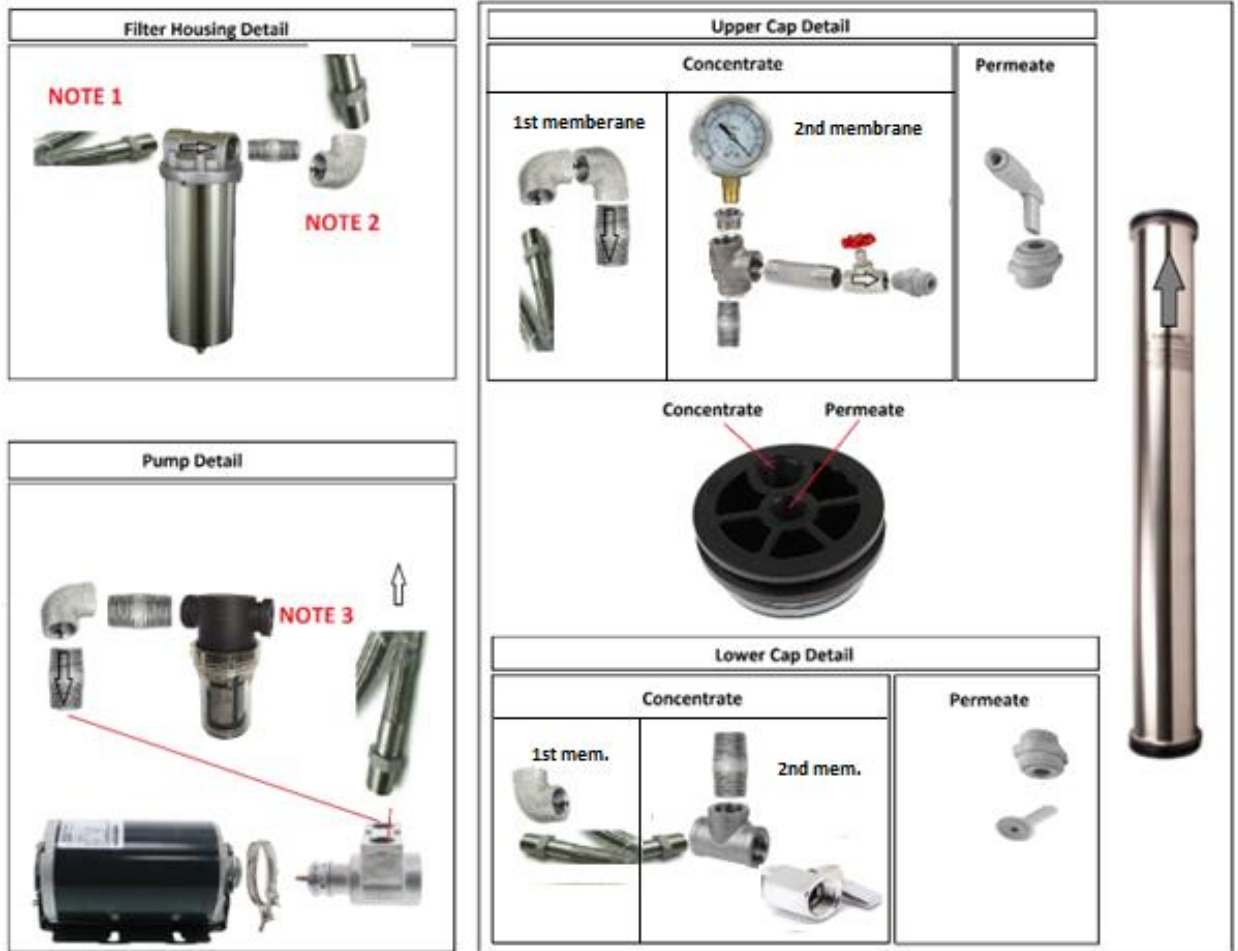

Note: 90 degree street elbows may be supplied in place of elbows and close nipples.

Note 1: You will need to install the hose with the swivel between the pump and the prefilter inlet

Note 2: Use the hose without the swivel connector to connect the filter outlet to the 1st

Note 3: You will need to provide your own inlet fitting and tubing. We recommend a minimum 3/4" hose barb fitting (1/2" npt x 3/4" barb) and 3/4" id vinyl tubing. The tubing should be as short as possible and strong enough to not collapse due to the suction.

Membrane Installation:

Your membrane has already been installed into the housing. The u cup seal should be at the top of the membrane, facing down (as pictured below). This allows the stainless housing to drain properly (when utilizing the bottom drain port). Additionally, the membranes are directional (as indicated by the embedded logo on the membrane). The flow arrow on the membrane should be pointing "up". There is no need to remove the membrane from the housing as it is already installed.

