

# Single Post Kit Parts List and Schematics

## Pumps

- 1 x 250psi Stainless Vane Pump
- 1 x 3/4hp 120/240v AC drive motor
- 1 x vane pump band clamp

## Filters/Housings

- 1 x Intake strainer assembly
- 1 x Stainless 10" prefilter housing
- 1 x 4040 Stainless Membrane Housing Kit
- 1 x bolt kit
- 1 x Styrofoam spacer

## Hose

- 2 x stainless high pressure hose
- 25' 1/2" OD HDPE tubing (discharge tubing)

## Fittings

- 6 x 1/2" mnpt x 1/2" push connect straight
- 2 x 1/2" stem x 1/2" push connect elbow
- 1 x 1/2" stem plug
- 1 x 90 elbow fitting
- 6 x 1/2" mnpt x 1.5" nipple
- 1 x 1/2" mnpt x 2.5" nipple
- 2 x 1/2" female "t"
- 1 x 1/2" female cross
- 2 x 1/2" npt flow valve
- 1 x 1/2" mnpt x 1/4" fnpt reducing bushing
- 1 x 1/2" mnpt x fnpt isolation/drain valve
- 1 x 1/4" mnpt pressure gauge

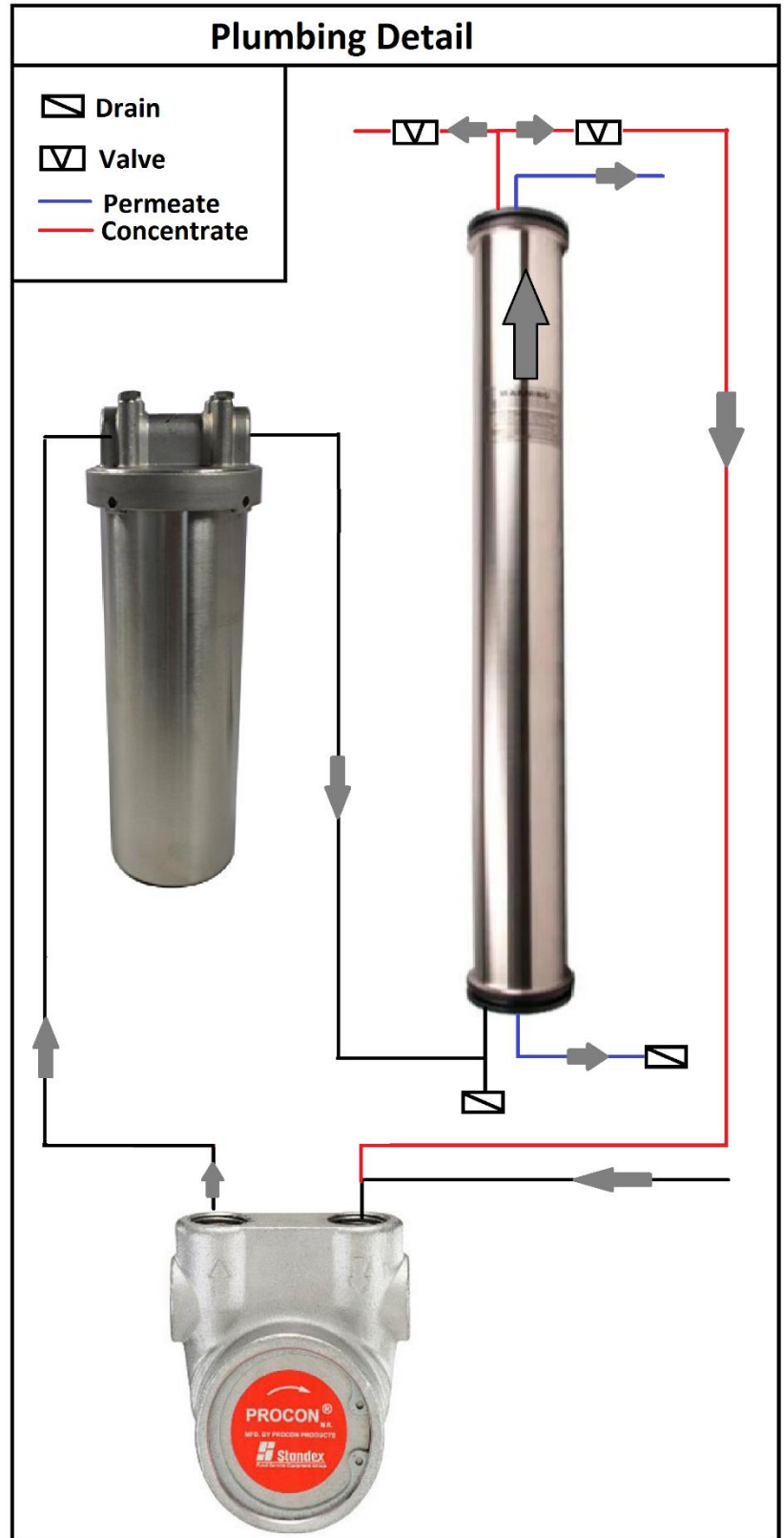

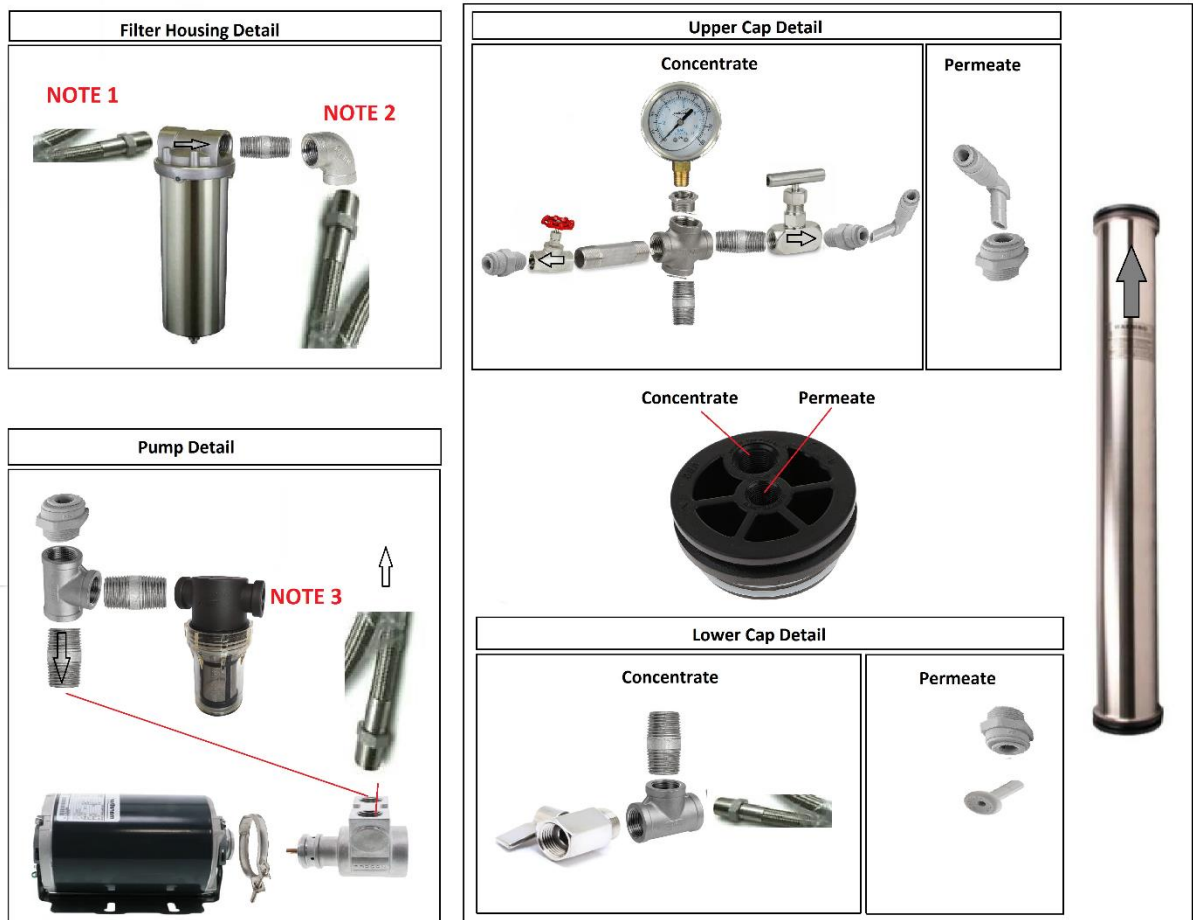

Note 1: You will need to install the solid (hose without the swivel) hose onto the pump first, then spin the other end onto the prefilter housing BEFORE bolting the prefilter housing to the cart or plumbing the outlet of the prefilter housing.

Note 2: Use the hose with the swivel connector to help with this installation

Note 3: You will need to provide your own inlet fitting and tubing. We recommend a minimum 3/4" hose barb fitting (1/2" npt x 3/4" barb) and 3/4" id vinyl tubing. The tubing should be as short as possible and strong enough to not collapse due to the suction.

### Membrane Installation:

Your membrane has already been installed into the housing. The u cup seal should be at the top of the membrane, facing down (as pictured below). This allows the stainless housing to drain properly (when utilizing the bottom drain port). Additionally, the membranes are directional (as indicated by the embedded logo on the membrane). The flow arrow on the membrane should be pointing "up". There is no need to remove the membrane from the housing as it is already installed.

